

NOTES:  
1.

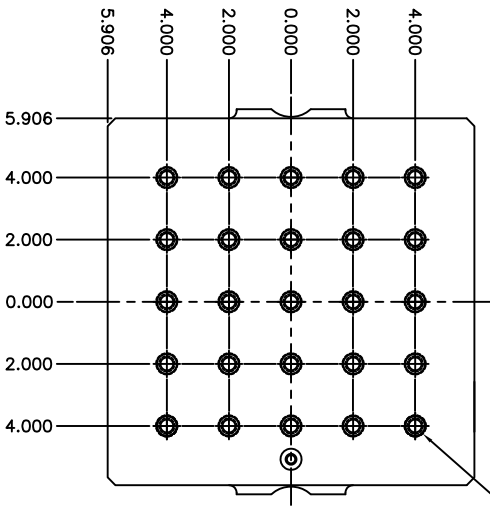

④ 90° C'SINK  $\phi 0.650/0.660$   
 $\phi 0.640/0.645$  X 0.83DP  
 11/16-11UNC X 0.70DP  
 25 PL  
 1/2-13UNC S.S. INSERT

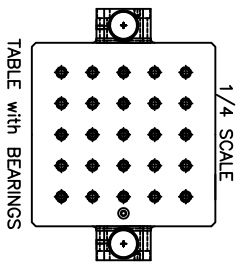
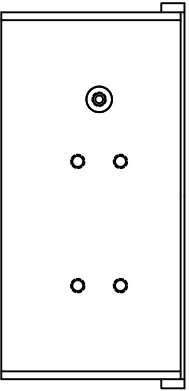
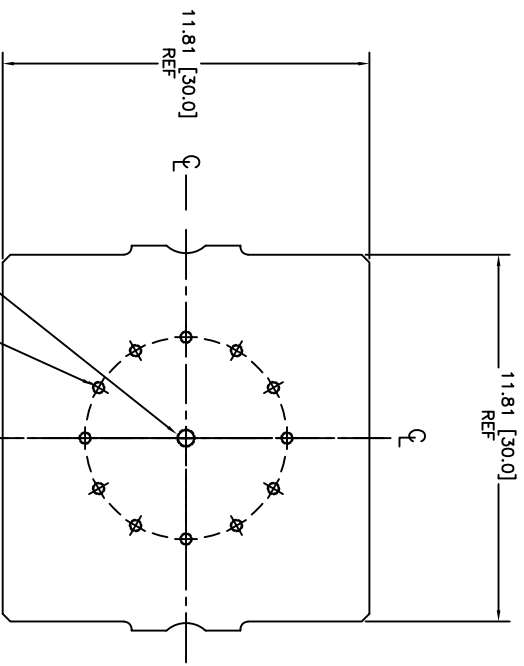
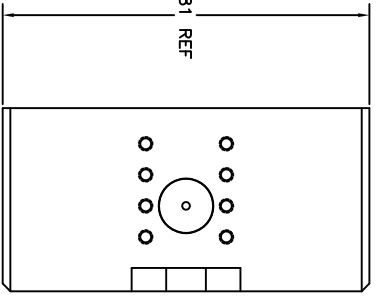

90° C'SINK  $\phi 0.572/0.582$   
 $\phi 0.515/0.520$  X 0.70 DP  
 9/16-12UNC X 0.56DP  
 3/8-16UNC INSERT  
 ③

②  $\phi 3.30/3.37$ , T.65  
 $\sqrt{\phi 3.95 \times 82}$   
 3/8-16 UNC-2B, T.40  
 12 HOLES, EQUALLY SPACED  
 ON  $\phi 6.500$  B.C.  
 10-32UNF THREADED INSERTS (12 PL)

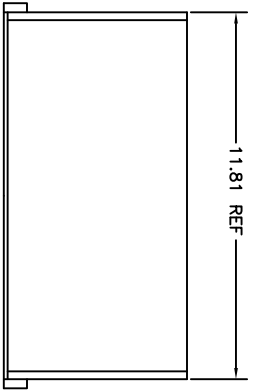

REV.		DESCRIPTION		DATE		APPROVED	
A	EEO # 389X			11/2020		KDN	

REVISIONS

REV.	DATE	DESCRIPTION	BY	APP.
1	11/2020	ASSY TABLE	KDN	
2	11/2020	2 IN GRID, P300S	KDN	
3	11/2020	107XXX	KDN	

LANSMONT CORP.  
 ASSY TABLE  
 2 IN GRID, P300S  
 107XXX  
 1 of 1

REV.	DATE	DESCRIPTION	BY	APP.
1	11/2020	104828-7-BI TABLE, MACH. 30 X 30, 6061-16	KDN	
2	11/2020	107XXX	KDN	
3	11/2020	107XXX	KDN	

LANSMONT CORP.  
 ASSY TABLE  
 2 IN GRID, P300S  
 107XXX  
 1 of 1