

New Student Day 2012

General Assembly, 1 to 1:30 pm, 1:45 to 2:15 pm and 2:30 to 3 pm: Faculty Lounge

(Session is the same each time. Please attend one session.)

Welcoming and informational remarks from: Dr. Michael Matthews, Associate Dean of Academic Planning; Dr. Jed Lyons, Interim Associate Dean, Student Services; and Ms. Helen Fields, Assistant Director of the Career Center

Departmental Meet and Greet and Student Organization Information Session, 1 to 3 pm: *Various locations*

Please use both sides of this map to locate and visit with your department chair and faculty and to learn more about our student organizations.

Inside Exhibits

1. Faculty Lounge - general assemblies
2. Career Center
3. CSE Game Design and Programming class demos and interactive game demos
4. USC Libraries/Thomas Cooper Library
5. Gamecock Toastmasters
6. Student Veteran Association at USC
7. **Biomedical Engineering:** Dr. Abdel Bayoumi, director Biomedical Engineering Society (BMES)
8. National Society of Black Engineers (NSBE)
9. Concrete Canoe and Steel Bridge teams (ASCE)
10. USC Ultimate Frisbee Club
11. Institute of Transportation Engineers (ITE)
12. Society of Women Engineers (SWE)
13. Engineering and Computing Living and Learning Community
14. Pi Mu Epsilon/Gamecock Math Club
15. Columbia Linux Users Group
16. GamecockFIRSTers/Los Pollos Locos FRC Team 2815

Outside Exhibits*

- Concrete Canoe Team
- Electric Car conversion project
- Hydrogen Scooter Car
- Steel Bridge Team
- USC Ultimate Frisbee Club game demo

*weather permitting

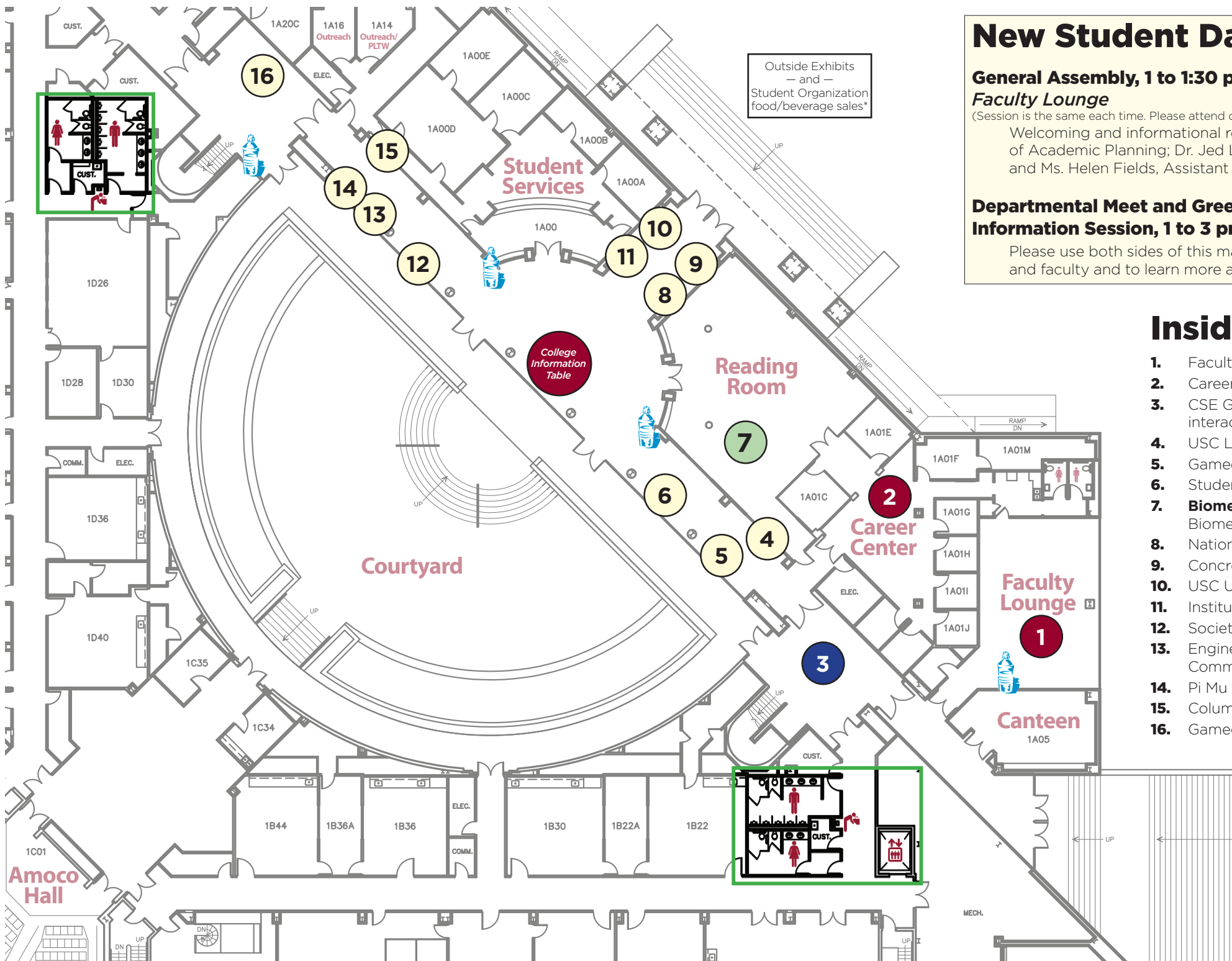

Outside Exhibits
— and —
Student Organization
food/beverage sales*

Second Floor

- 1. Civil and Environmental Engineering:** Dr. Robert Mullen, chair
Engineers Without Borders (EWB-USA)
- 2. Mechanical Engineering:** Dr. Jamil Khan, chair
Aerospace Engineering (new minor and masters program)
American Society of Mechanical Engineers (ASME)
- 3. Nuclear Engineering:** Dr. Travis Knight, acting director
American Nuclear Society (ANS)
- 4. Computer Science and Engineering:** Dr. Michael Huhns, chair
- 5.** Association for Computing Machinery (ACM)
- 6. Electrical Engineering:** Dr. Roger Dougal, chair
- 7.** American Society of Civil Engineers (ASCE)
Chi-Epsilon Honor Society
- 8. Engineering Science:** Dr. John Bowles, director
- 9.** Theta Tau professional engineering fraternity
- 10.** Institute of Electrical and Electronics Engineers, Inc. (IEEE)
IEEE-Power Electronics Society (IEEE-PES)
- 11.** Electrical Engineering Lab
- 12.** Human Fall Detection device demonstration (CEE research)
- 13. Chemical Engineering:** Dr. John Weidner, chair
- 14.** American Institute of Chemical Engineers (AIChE)
ChemE fuel cell/chemical reaction car team

 Water coolers provided throughout the first and second floors of Swearingen Engineering Center. Look for this symbol for locations. A limited number of souvenir cups are available on a first-come, first-served basis from the Information Table on the first floor in the lobby.

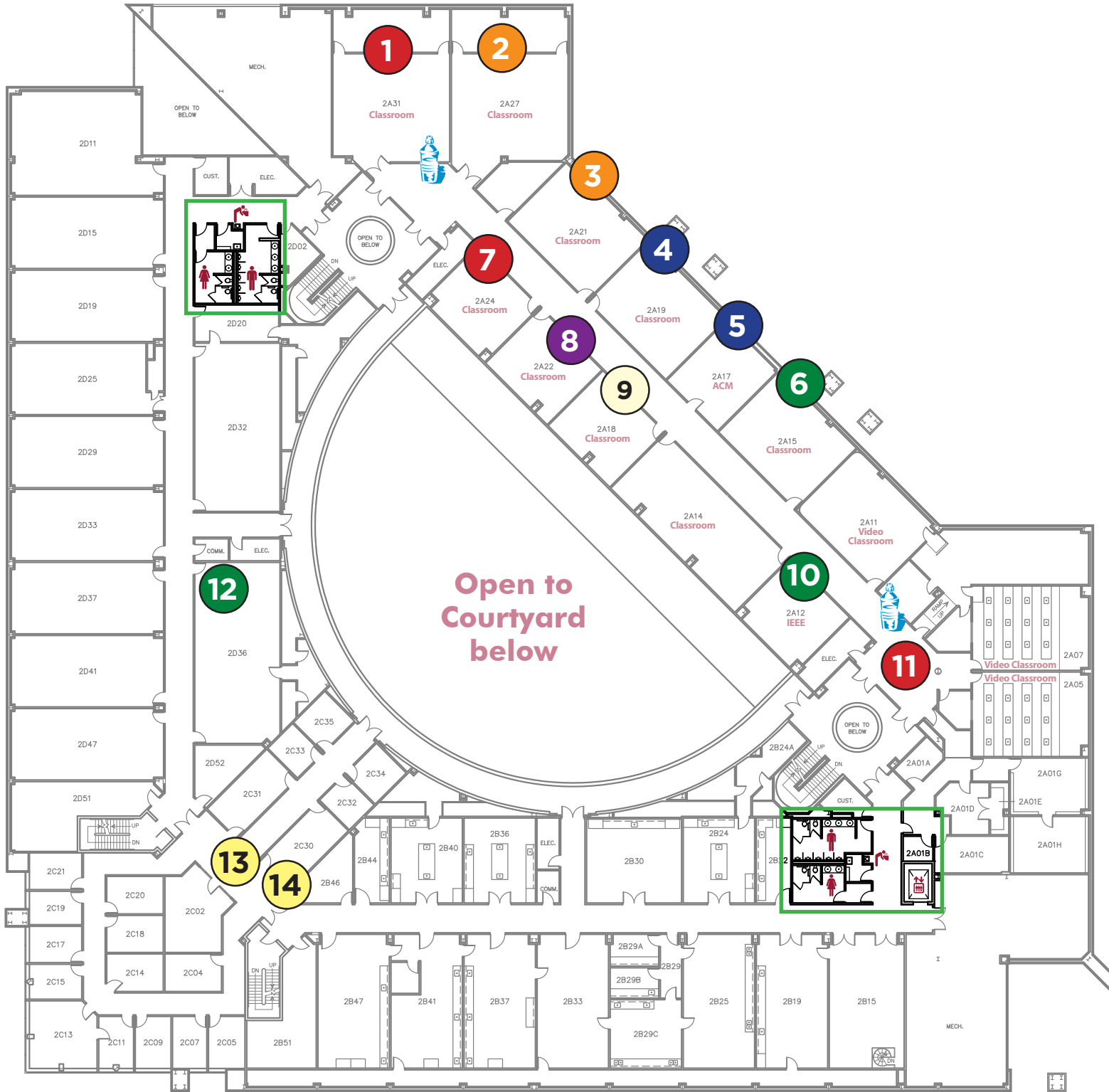

UNIVERSITY OF
SOUTH CAROLINA
College of Engineering
and Computing

